



## Problem of the Week

### Problem A

### School Clean Up

Every year the students at Spotless Elementary do an outdoor cleanup. First, the school yard is divided into three sections:  $A$ ,  $B$ , and  $C$ .

A map of the school yard is shown, with all given lengths in metres. Note that the school yard is a square, the school is a rectangular U-shape, and the diagram is not drawn to scale.

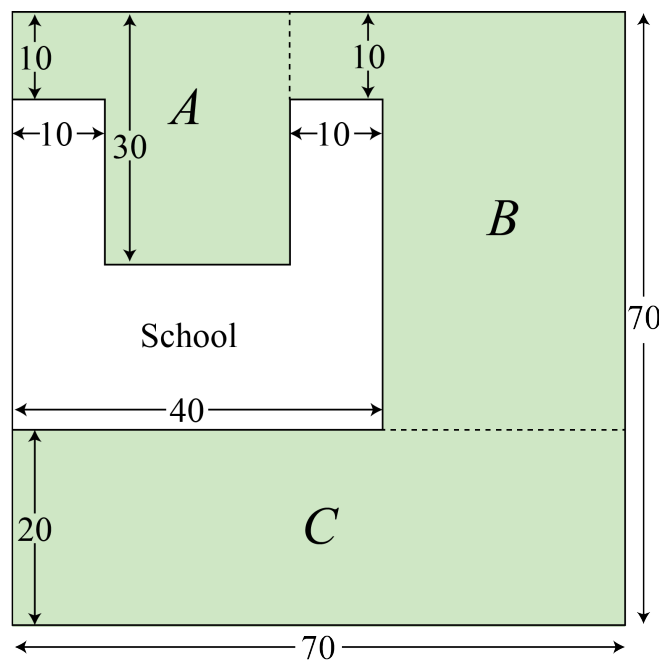

The Grade 1 & 2 students are assigned the section with the smallest area, the Grade 5 & 6 students are assigned the section with the largest area, and the Grade 3 & 4 students are assigned the remaining section. Determine which section is assigned to each grade. Justify your answer.